

# Year 11 parents and carers revision support evening

**Sandra Manning (Assistant Headteacher)**

**Hannah Holmes (Assistant Headteacher)**

**Joe Riches (Director of Key stage 4)**





# Plan for this evening:

1. The procedures and expectations around the formal GCSE examinations – S Manning
2. How you can support your child through this last few months and the GCSE examination period – H Holmes
3. End of year celebrations – prom/leavers day/year book

# Important dates and deadlines – for your child – but we need you to be aware



- Year 11 Spring Mocks – Week beginning 17<sup>th</sup> March 2025 (1 week only) – copy of timetable sent home with your child's year 11 report on Friday. Also emailed to you and them.
- NEA / coursework – letter emailed to all parents in January
  - DT and Engineering are due 7<sup>th</sup> May
  - Child Development will be due 15<sup>th</sup> May
  - Food and Hospitality are 5<sup>th</sup> May
  - Dance is due 7<sup>th</sup> May
  - Drama (Performing Arts) is due 5<sup>th</sup> May
  - Music is due 15<sup>th</sup> May
  - PE is due 15<sup>th</sup> May
- Real GCSE exams – **9<sup>th</sup> May to 18<sup>th</sup> June 2025** (contingency dates 11<sup>th</sup> June and 25<sup>th</sup> June)
- Leavers day tbc
- Prom 27<sup>th</sup> June

# Examination rules – National Expectations

- Silent as enter, remain silent throughout and leave in silence
- Must not attempt to communicate with anyone other than seeking support from the invigilators (hands up)
- Cannot bring electronic devices into the exam hall/rooms – phones, watches etc – if found on their person must report to exam board who can disqualify
- Cannot leave the exam hall/room early
- No notes/papers taken into the exam hall/room
- Water bottles – colourless and transparent (containing water) no labels on the bottles
- Pencil cases – colourless and transparent – **MUST USE BLACK PENS!**

# Uniform expectations in GCSE examinations

- Pupils are expected to wear correct Neatherd uniform throughout the exams:
  - blazers worn if cold (no sweatshirts/hoodies will be permitted)
  - school shoes to be worn (no trainers permitted)
  - summer polos are permitted (if we are wearing them) be aware the sports hall can be very cold (see note about blazer)
  - no watches are allowed in the exam rooms (clocks on walls)

# Behaviour expectations in GCSE examinations

- Pupil behaviour is closely monitored by the invigilators during examinations – they are in charge.
- Anyone whose behaviour is disturbing the examination room will be removed – this could result in all of their examinations results being void
- Pupils are expected to remain in the examination room for the duration of the exam and will not be permitted to leave (they are required to remain silent and not communicate until they leave the examinations room)
- Pupils will be required to attend the line –ups/warm ups as allocated (no opting out)
- Pupils must arrive on time to school 0835 as normal and remain for the whole day. Please do not ask for permission for your child to leave – they need to be in lessons with the experts helping them

# Absence during GCSE examinations (National guidance)

- If a pupil misses an exam, unless they have a medical reason, they will be awarded a 0 mark – no you can't go on holiday 😊
- Supporting medical evidence is required if a pupil misses an exam due to illness. You must contact your GP/seek medical support – this may/may not be accepted by the exam board.
- Your child should attend their exams – having a cold, migraine, stomach upset will not be enough for them to get dispensation from the exam boards – they are very strict.

# Lateness during GCSE examinations (National guidance)

- If your child arrives late (eg late bus) they should report to main reception. As long as they arrive within the official examination window (usually 1hr after the papers have been opened) the school will permit them to sit their exam
- If your child arrives late to school (with no reasonable explanation) it will be up to the school's discretion as to whether they are permitted to attend the examination – if you drop your child off – please ensure they are here no later than 0835.
- If pupils arrive late to the afternoon examinations, again the school has discretion on whether to permit them to sit the exam.



# Storage of personal items during examinations

- Containers – opened at 0835 and closed (and locked) once the examination starts
- Hooks for coats and bags
- Lighting
- Staff on hand to support

Pupils must store their personal items, including mobile phones/watches, in their bags in the storage containers. There will be no option for items to be kept elsewhere.

# Bespoke support provided during GCSE examinations

- Warm up sessions at form time for some subjects
- Breakfast club available to all year 11
- Homework and revision club after school continues
- Lessons continue until selected date – usually 2<sup>nd</sup> week after May half term tbc
- Form tutors available every morning to support (inc on days of exams)
- Early lunch break to ensure all have eaten prior to exams.
- Lunchtime and after school revision sessions

# Study leave – a thing of the past

- Schools are no longer permitted to allow pupils to go on ‘study leave’ as they used to. Spending time at home prior to the exams beginning.
- Schools are permitted to select a date when they state pupils no longer have to attend for full days, this is only permitted to happen once the major examinations have begun eg English, maths and science. Most schools keep their pupils until all of the paper 1s have been completed. Some schools keep pupils in school throughout the whole exam period – so until 18<sup>th</sup> June.

# Current support in place for year 11 pupils

- Bespoke tutor groups – with a focus on an area of development for your child
- Bespoke/invite only revision sessions at lunchtimes and after school across all subjects – we need your help here!
- Drop-in revision sessions being offered at lunchtime and after school – will increase as we get closer to the exams
- Homework club – in library and Gateway offering support
- Form time programme of revision techniques
- In class revision and support

Supporting your Year 11 child... hold on to your hats it could get a bit bumpy!



# 1. Prepare to succeed

## **Revision timetable:**

- topics, not subjects
- Interleaving
- 30 min chunks
- Active breaks built in
- Pinned up in a shared space so you can help them stick to it!

## **Study space:**

- free from distractions
- resources nearby



## 2. The Pomodoro Technique

- Set a timer
- Complete 25 minutes continuous, uninterrupted revision
- Take a 5 minute break
- Repeat up to 4 times
- Take a longer 30 minute break



Free Pomodoro apps include Flora, Tick Tick, Focus To-Do, Focus Keeper



# 3. Active revision - flashcards

## The Leitner System

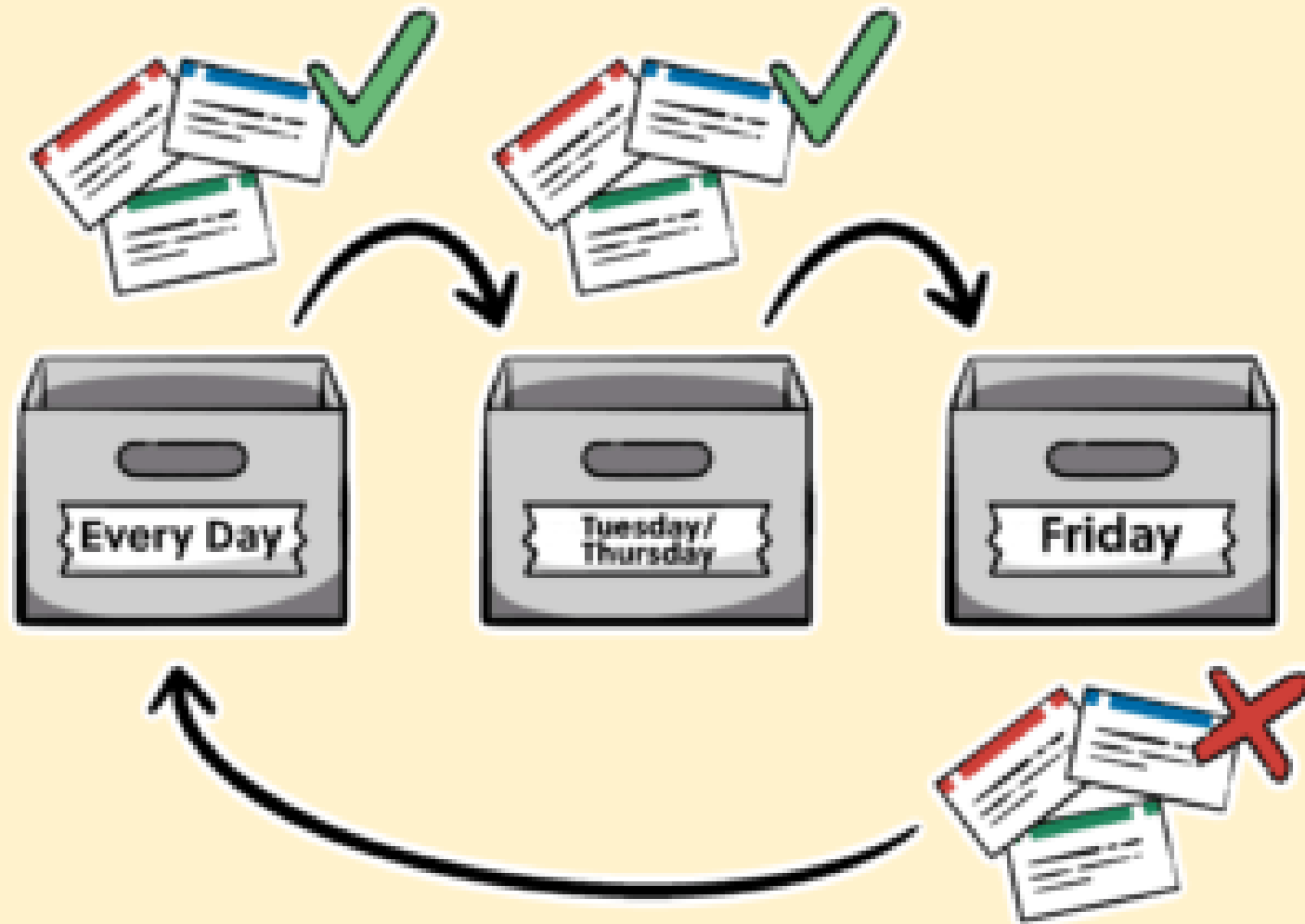



# 4. Active revision – mind maps

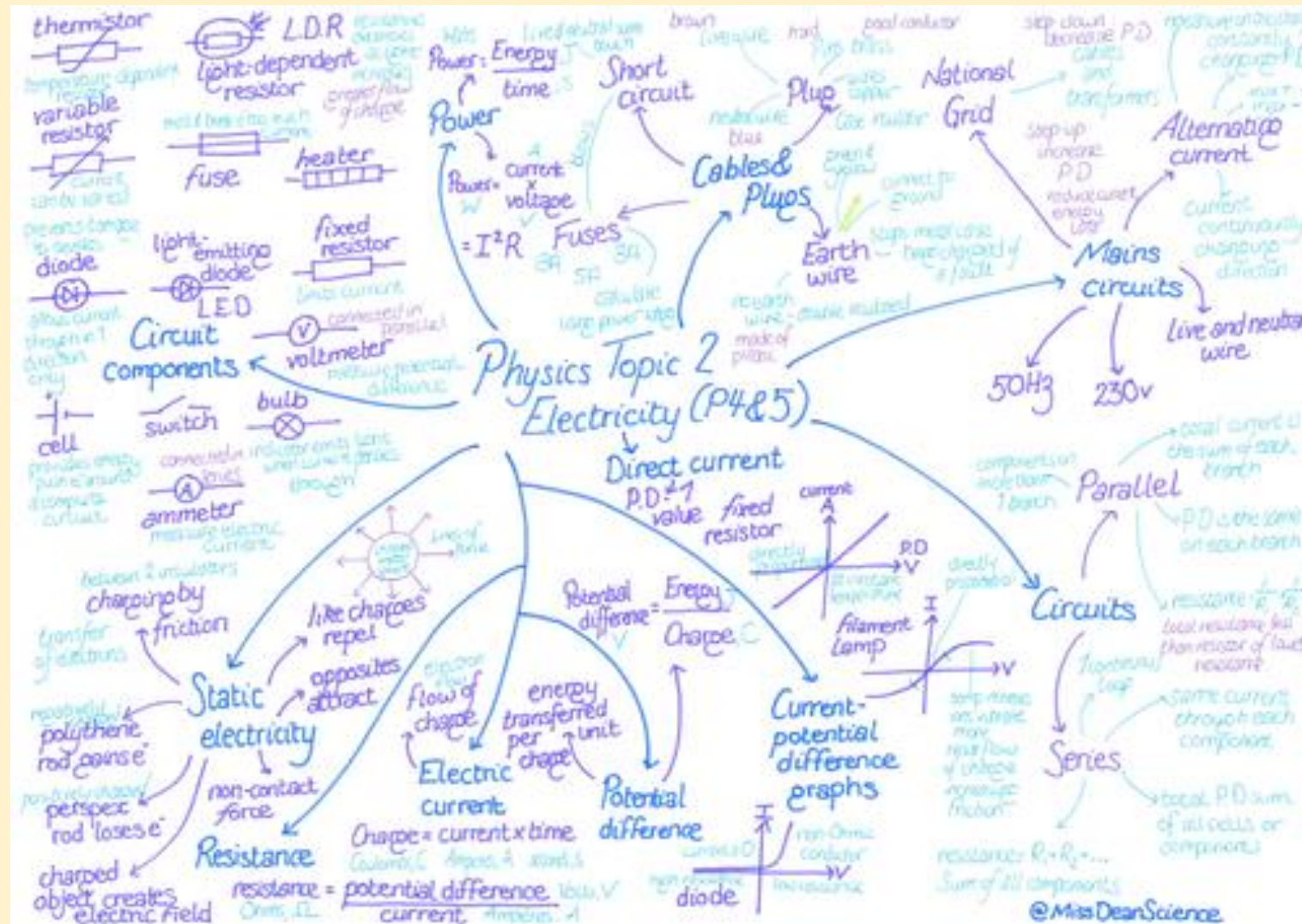

@MissDeanScience



# 5. Active revision – Cornell note taking

- Use it when working with a textbook, revision book or going over your notes from lessons.
- This method prompts you to make choices about the main pieces of information.
- The summary should be as simple and concise as possible.

<u><b>TITLE</b></u>		Date
Keywords	Main notes * ideally using abbreviations	
Questions	Key thoughts	
<b>SUMMARY</b>		



# 6. Further active revision techniques

- Timelines
- Venn diagrams
- Read, cover, write, check
- Self-testing
- Practice exam questions  
Teams, teachers, exam board websites, [List of courses](#)

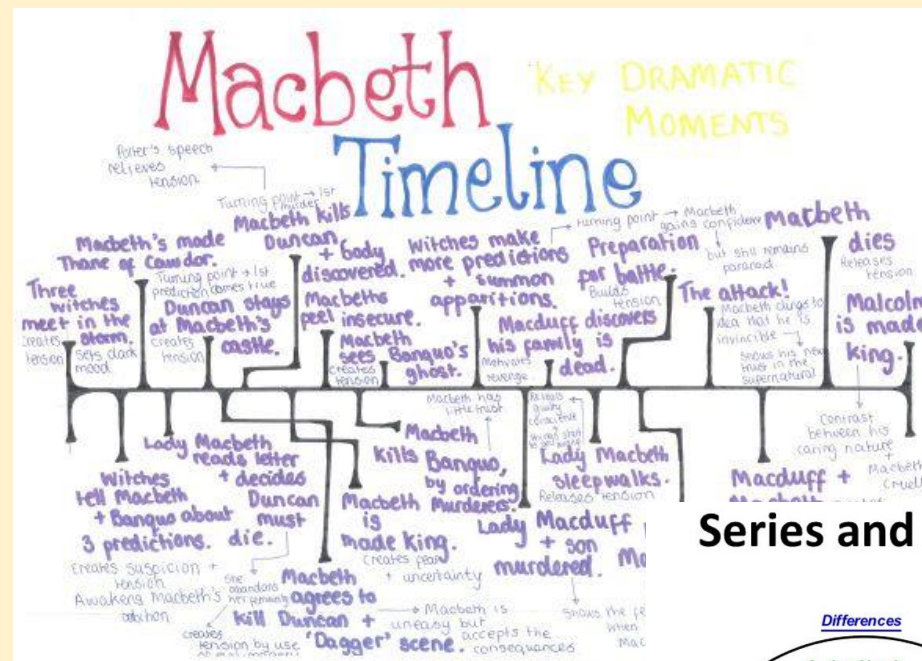

## Series and Parallel Circuit

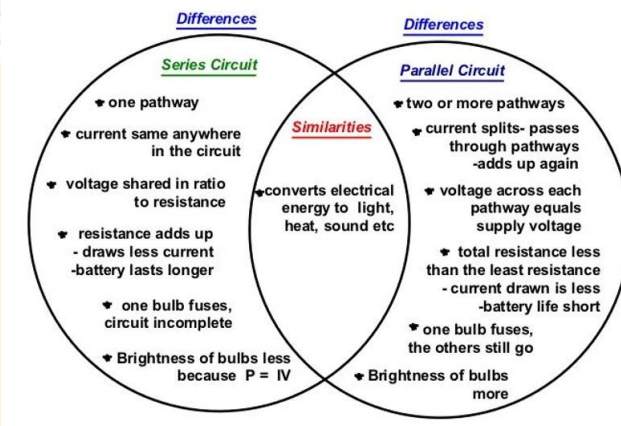

# 7. Where to find information and support



- Exam board websites
- School website
- Tutors, Mrs Smith, Mr Riches, Miss Manning and me



# 9. Prom!

**27<sup>th</sup> June 2025**

Wensum Valley Golf Club

Pupils are **invited** to prom – it is a privilege and a reward (not a right).

Pupils with poor unauthorised attendance, poor effort in lessons, poor behaviour, truancy or not attending an exam are at risk of not receiving their invitation to prom.

Pupils on the 'risk list', will know. Mr Riches will speak to them about why they may not be invited and will give them the chance to turn things around.

# Leavers day, Leavers Hoodies and Leavers Book



- Date tbc
- Is before the end of the full exam period – when school decided pupils no longer are required to attend
- Smart and appropriate clothing is required – usually happens after a whole cohort exam



# Important dates and deadlines

- GCSE PE practical exams: w/c 24<sup>th</sup> February
- Year 11 spring mocks: w/c 17<sup>th</sup> March 2025
- GCSE drama assessment: 2<sup>nd</sup> and 3<sup>rd</sup> April
- GCSE French and Spanish speaking exams: 23<sup>rd</sup> – 29<sup>th</sup> April
- GCSE photography exam: 30<sup>th</sup> April
- GCSE art exam: 6<sup>th</sup> – 9<sup>th</sup> May
- Real GCSE exams – 8<sup>th</sup> May to 19<sup>th</sup> June
- Prom – 27<sup>th</sup> June